

## PARTS LIST

Extra parts are available direct from Hogue

1. Fitting Layers . . . . . \$5.00
2. Washers . . . . . \$2.00/set
3. Locking bolt extension . . . . . \$5.00/set
4. Locking bolt . . . . . \$5.00
5. Bolt actuator . . . . . \$10.00
6. Bolt spring . . . . . \$7.00
7. Bushings . . . . . \$10.00/set
8. Bolt layer . . . . . \$8.00
9. Outside layer . . . . . \$8.00
10. Magnet Layer . . . . . \$15.00
11. High-rise belt plate . . . . . \$20.00
12. Competition belt plate . . . . . \$35.00
13. Screws (4) . . . . . \$9.00/set
14. Barrel retainer plate . . . . . \$5.00
15. Barrel retainer . . . . . \$5.00
16. Adjustment washers . . . . . \$2.00/set
17. Set screw . . . . . \$1.00
18. Magnets (3) . . . . . \$15.00

## ACCESSORY KITS

Available in 2000

### AUTOMATIC LOCKING BOLT KIT

Spring-loaded bolt automatically locks upon holstering

### SECURITY KIT

Key lockable bolt  
Call for Prices  
1-805-239-1440

## ATTENTION

READ AND FOLLOW ALL INSTRUCTIONS AND WARNINGS

**Before you start, make sure your gun is unloaded with no round in the chamber.**

**Never do any adjustment on this holster using a loaded pistol.**

## NEVER PRACTICE DRAWING A LOADED PISTOL.

Your Hogue pistol holster should only be used with guns that fit properly. Before adjusting your new holster to fit, be sure your gun is unloaded and that you follow the assembly and adjustment instructions provided with this product.

Check all functions of your gun and holster after the holster is properly adjusted to make certain the gun is held safely, and that the locking bolt will not contact the trigger under any circumstances. If you do not feel competent to check the safety and proper function of your holster yourself, have your gunsmith check this for you.

Finally, it is important to field test the function of your holster under controlled conditions but before actual use in the field to be certain it functions properly, holds the gun safely, and securely, and that you can draw and handle the gun safely.

Figure 8

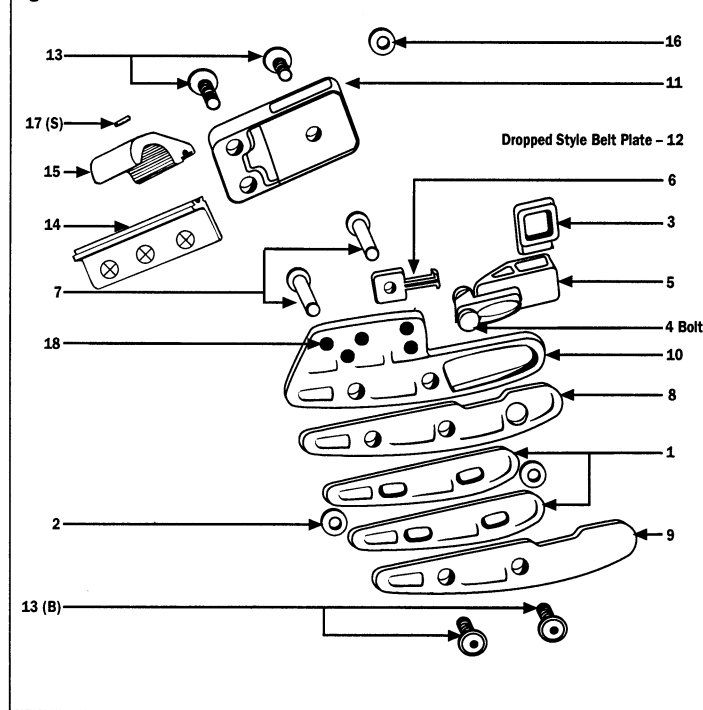

## IMPORTANT INFORMATION ABOUT YOUR HOGUE POWERSPEED HOLSTER

Your Hogue pistol holster should only be used with guns that fit properly. Before adjusting your new holster to fit, be sure your gun is unloaded and that you follow the assembly and adjustment instructions provided with this product. Check all functions of your gun and holster after the holster is properly adjusted to make certain the gun is held safely. If you do not feel competent to check the safety and proper function of your holster yourself, have your gunsmith check this for you. Finally, it is important to field test the function of your holster **under controlled conditions but before actual use** in the field to be certain it functions properly, holds the gun safely and securely, and that you can draw and handle the gun safe.

### NEVER PRACTICE DRAWING

#### A LOADED PISTOL

All firearms are potentially dangerous; their use may cause great harm, personal injury or death. It is your responsibility to know the safe use, procedures and operation of your firearm, and to store, handle and transport your firearm safely. Proper training is available through accredited firearm safety training programs.

## - WARNING -

**It is imperative that you field test your holster under controlled conditions, with an unloaded gun, to make sure it functions properly and holds the gun safely and securely.**

**In full race mode the gun can fall out. Extreme care must be taken when the holster is unlocked. Any movement prior to the draw should only be done with the holster in fully locked mode.**

**Some extended magazine releases will interfere with the holster and cannot be used without proper clearance.**

**Bulky clothing or body armor can contact the locking mechanism. Make sure the holster will stay locked in all positions ie: sitting, standing, etc.**

**The magnets are strong!**

**Do not place the holster near any magnetic media such as credit cards, cassette tapes, computer disks, etc. The information on them will be lost.**

## - WARNING -

## CUSTOMER SATISFACTION

**Customer satisfaction is our number one priority.** Do not hesitate to contact us with any problems. We will do our absolute best to help. If you are not completely satisfied with your Hogue holster for any reason, you may, with proof of purchase, return it to the place of purchase within thirty (30) days for a full refund or replacement. Due to manufacturing variations in the gun frames, and the wide variety of guns that may be used in this holster, we do not warrant that your holster will function correctly with any specific firearms. Except for your right to return the holster for replacement or refund within thirty (30) days, this product is sold "AS IS" and "WITH ALL FAULTS." To the extent allowed by law, we specifically disclaim any express or implied warranties, including, but not limited to, warranties of merchantability and fitness for a particular purpose.

Inquiries concerning any Hogue product should be sent to:

Hogue, Inc.  
P.O. Box 1138  
Paso Robles, CA 93447  
or phone (805) 239-1440  
between 9 a.m. and 5 p.m. P.S.T.

**HOGUE®**  
**POWERSPEED™** UNIVERSAL SPEED HOLSTER

## ASSEMBLY INSTRUCTIONS



**IMPORTANT CONSUMER AND WARRANTY INFORMATION INCLUDED AND ON BACK OF PACKAGE**

**READ ALL WARNINGS CAREFULLY**

## Assembly:

If you feel at all uncertain regarding the assembly or adjustment of this holster, let your gunsmith do it for you.

The holster comes assembled in a right-handed configuration with most parts, some of which you may or may not need. For left-handed use, disassemble the holster and reassemble in a left-handed orientation.

### 1. Make sure your pistol is unloaded and no round is in the chamber.

2. Size the holster to precisely fit your pistol's trigger guard. (Refer to Fig. 1 and to Fig. 8, the exploded drawing on reverse side of page) Remove the bolts (b) and add or subtract the fitting layers (1) or the fitting washers (2) to match the width of your trigger guard. Try to use the fitting layers first and if they do not meet the width of the trigger guard exactly, use the washers. It is mandatory for proper holster operation that you adjust the width to match your pistol's trigger guard width exactly. Replace the bolts and loosely tighten to allow the layers to move.

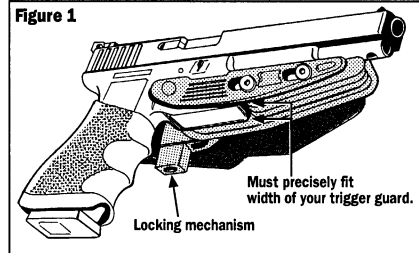

3. Adjust the holster to precisely fit your pistol's shape. (Refer to Fig. 2) Make sure the bolts (b) are loose enough to allow the layers to move. Place your unloaded pistol into the holster and pull up on the locking mechanism (L) all the way to fully engage the locking bolt (4) into the trigger guard. Pull upward and forward on the pistol while at the same time pushing the fitting layers (1) and the outside layer (9) up into a position that they will hold the pistol trigger guard firmly against the locking bolt (4). Further adjust the outside layer to provide a stable hold on the pistol and a complete covering of the trigger. The holster must be set up to cover the trigger in both single and/or double action modes. While holding the pistol and holster layers in place firmly tighten the bolts (b). (Refer to Fig. 3)

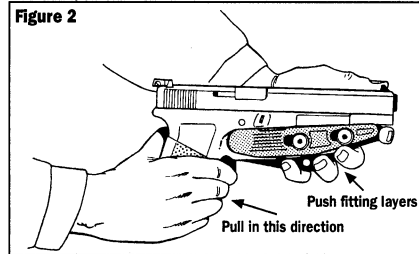

4. Determine if you need to use the optional barrel retainer as follows: With the pistol locked in the holster determine if the pistol barrel will rotate forward an unacceptable amount and is held securely (see warning and refer to Fig. 4). This is dependent on the particular pistol's configuration, your needs, and how the holster is going to be used. If the barrel retainer is not used the magnets can be moved into the holes that allow them to best hold the barrel.

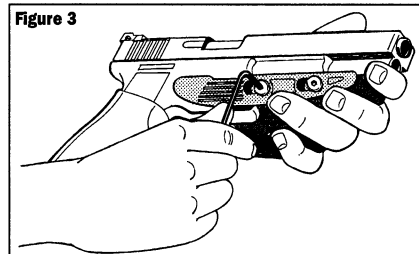

### WARNING – WARNING

We recommend that the optional barrel retainer be used in all but strictly controlled competition situations. It is also recommended to use the barrel retainer on guns that by nature of their shape are not held securely by the magnets or are able to unacceptably rotate forward. It is mandatory to use the barrel retainer on any gun that can be rotated forward and fired by the locking bolt. Guns like the CZ-75 with a large round trigger guard are an example of a pistol that absolutely requires the barrel retainer (See Fig. 4). Pistols such as the Glock on the other hand are held very securely without the barrel retainer.

Figure 4  
If pistol rotates an unacceptable amount use optional barrel retainer.



**NOTE:** To fit pistols with scope mounts that interfere with the magnet layer, cut away part of the magnet layer along line shown in Fig. 5. This will not effect the returnability of your holster.

If the barrel retainer is required, drift out and remove one magnet and reposition the other two in the inner holes. Or you may take the magnets out all together. Position and insert the retainer plate (14) into the magnet layer as shown (refer to Fig. 5) and use the provided screws to expand and tighten the retainer plate mounting lugs into the magnet layer. The retainer plate may be installed in all three magnet holes or in just the bottom two, to extend its length if necessary. Then remove the set screw(s) from the retainer and slide the retainer (15) over the dove tail in the retainer plate. Adjust the retainer to fit your pistol and reinstall the set screw to lock the retainer on to the retainer plate. (Refer to Fig. 6)

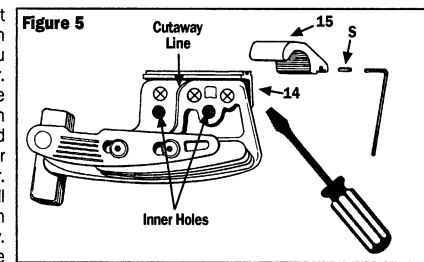

5. Install the belt plate appropriate for your use. (Refer to Fig. 7) The dropped style belt plate can be adjusted for position in several ways using the various mounting holes and angled washers (w). This belt plate can also be adjusted to clamp securely to belt sizes from 1-1/2" to 2" by adjusting the jack screws. For 2-1/4" belts, remove the jack bar and cut down to line indicated. Move nuts to alternate slots in jack bar and reinstall into slot in belt plate. (j). To secure, place the belt plate in position on the belt and tighten the jack screws to a point that securely locks the plate onto the belt. The belt plate is usable with belts larger than 2-1/4", just simply remove the adjustment assembly all together. Large washers can be used to adjust holster cant.

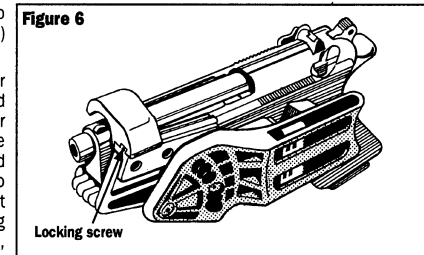

### IMPORTANT INFORMATION

Although this holster is modular and can be used with many pistols we do not warrant that it will work properly with all pistols. It is the responsibility of the user to properly assemble and determine the proper and safe operation of this holster with the pistols to be used. If in doubt as to the safe and proper function of this holster with your gun consult with a reputable gunsmith.

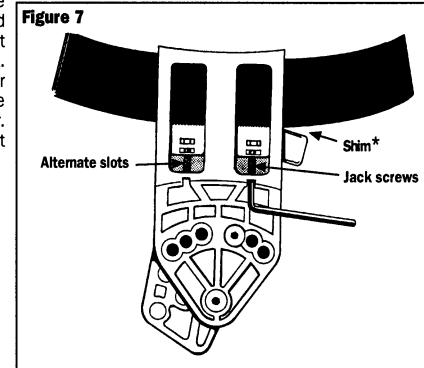

\* For belts smaller than 1-1/2" put shim here.

**DO NOT MAKE ANY ALTERATIONS OR MODIFICATIONS TO THIS HOLSTER.**

### WARNING

It is imperative that you field test your holster under controlled conditions, with an **unloaded gun**, to make sure it functions properly and holds the gun safely and securely. Make sure there is adequate clearance between the locking bolt (4) and the gun's trigger so there is no possibility of the locking bolt touching the trigger. Make sure the trigger **cannot** contact the locking bolt. Be especially careful of extended or flat faced triggers. Finally, make sure you can draw and handle the **unloaded gun** in a safe manner.